

SPECIFICATIONS

PROCESS CONNECTION	1/4" NPT
POROSITY	MEAN .0013" (MAX .0025")
HOUSING MATERIAL	303 STAINLESS STEEL
POROUS DISC MATERIAL	316 STAINLESS STEEL
PRESSURE RATING	10,000 PSI

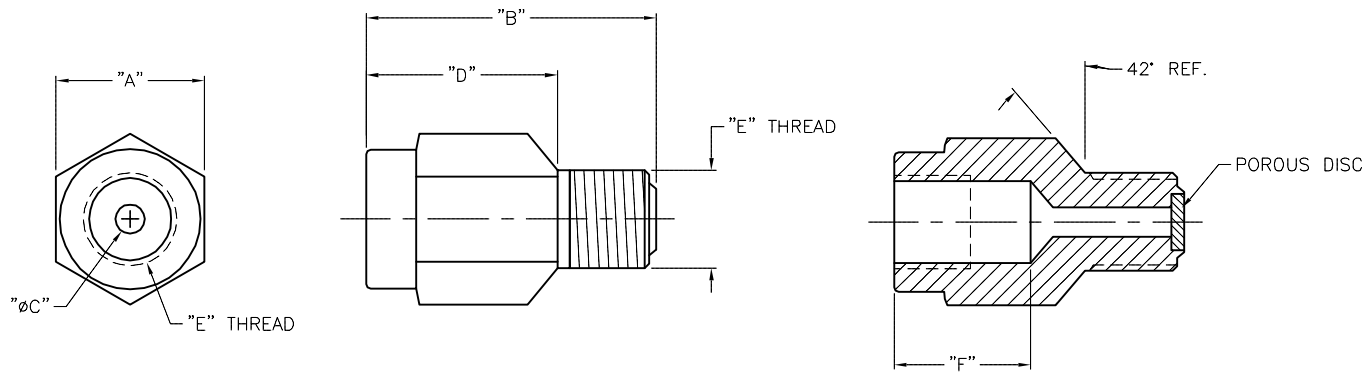

DIM. "A" HEX SIZE	DIM. "B" LENGTH	DIM "C" DIA. THRU	DIM. "D" BODY LENGTH	DIM. "E" EXTERNAL/ INTERNAL THREADS	DIM "F" INTERNAL MIN. DIA. DEPTH
3/4"	1 15/32"	1/4"	31/32"	1/4 NPT	11/16"

SOURCE DRAWING - FOR REFERENCE ONLY

RELATED DOCUMENTS		3RD ANGLE PROJECTION		THIS DRAWING IS CONFIDENTIAL AND THE PROPERTY OF TURCK INC. USE OF THIS DOCUMENT WITHOUT WRITTEN PERMISSION IS PROHIBITED.		3000 CAMPUS DRIVE MINNEAPOLIS, MN 55441 1-800-544-7769 (763) 553-7300 (763) 553-0708 fax www.turck.us	
1. 2. 3. 4.				DRFT RDS DATE 05/23/17 APVD N.J. SCALE 1=1.0		DESCRIPTION PSC-N1/4A4-WATER	
MATERIAL SEE SPECIFICATIONS		ALL DIMENSIONS DISPLAYED ON THIS DRAWING ARE FOR REFERENCE ONLY		UNIT OF MEASUREMENT MILLIMETERS		IDENTIFICATION NO. 100000741	
FINISH SEE SPECIFICATIONS		CONTACT TURCK FOR MORE INFORMATION		DO NOT SCALE THIS DRAWING		REV A	
A DRAWING RELEASE		RDS 05/23/17		FILE: 100000741		SHEET 1 OF 1	
REV DESCRIPTION		BY DATE ECO NO.					

A	DRAWING RELEASE	RDS	05/23/17	
REV	DESCRIPTION	BY	DATE	ECO NO.