

WIRING DIAGRAM

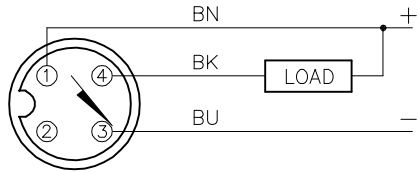

OUTPUT: AN6X

SHORT-CIRCUIT AND OVERLOAD PROTECTED

SPECIFICATIONS

PASS SPEED	≤ 10 m/s
HYSTERESIS	≤ 1 mm
TEMPERATURE DRIFT	≤ 0.1 mm
REPEAT ACCURACY	≥ ±0.1 mm
AMBIENT TEMPERATURE	-25°C to +70°C (-13°F to +158°F)
OPERATING VOLTAGE	10-30 VDC
RESIDUAL RIPPLE	≤ 10%
DC RATED OPERATIONAL CURRENT	≤ 150 mA
NO-LOAD CURRENT	≤ 15 mA
RESIDUAL CURRENT	≤ 0.1 mA
SWITCHING FREQUENCY	≤ 1.0 kHz
RATED INSULATION VOLTAGE	≤ 0.5 kV
OUTPUT FUNCTION	NORMALLY OPEN, 3-WIRE, NPN
SHORT-CIRCUIT PROTECTED	YES
VOLTAGE DROP	≤ 1.8 V
REVERSE POLARITY PROTECTION	INCORPORATED
WIRE-BREAK PROTECTION	INCORPORATED
HOUSING MATERIAL	PLASTIC, PP
MATERIAL ACTIVE AREA	PLASTIC, PP
CONNECTION	CABLE
CABLE	∅3.0, Lif9Y-11Y, TPU/GRAY
SHOCK RESISTANCE	30 g, 11 ms
VIBRATION RESISTANCE	55 Hz, 1 mm AMPLITUDE (IN ALL 3 PLANES)
PROTECTION DEGREE	IP68
SWITCHING STATUS INDICATION	LED: YELLOW

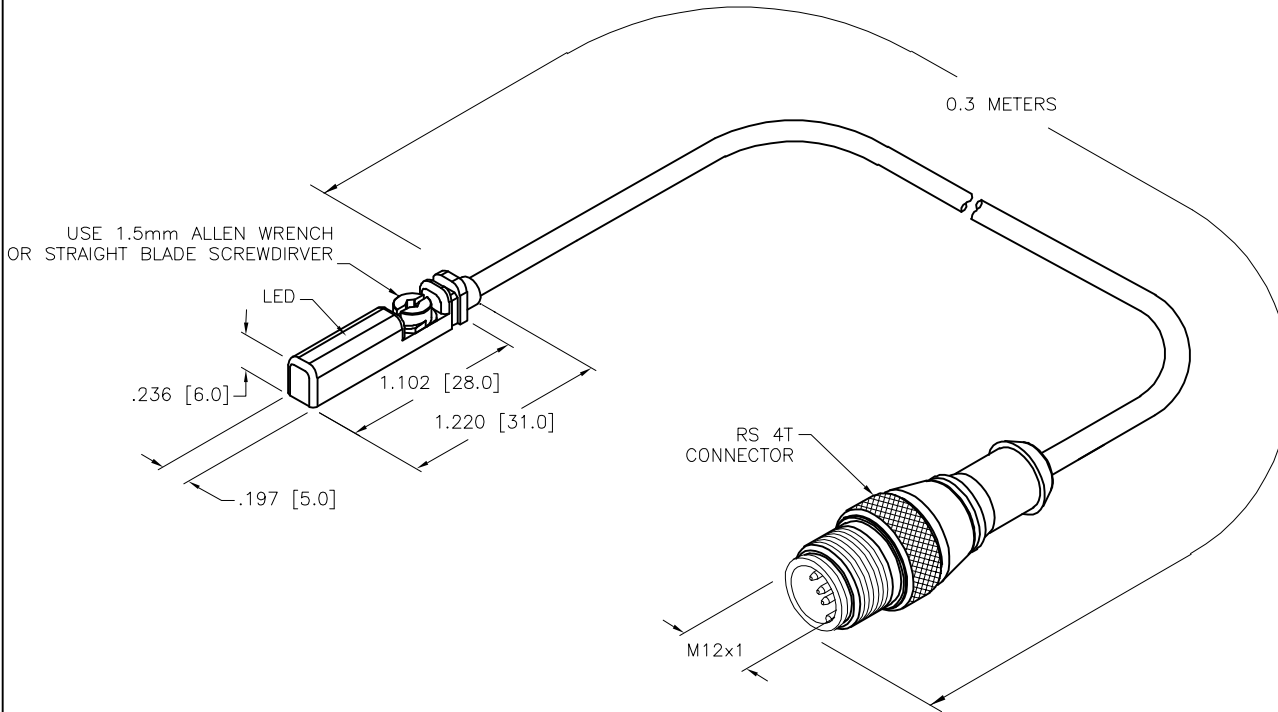

USE 1.5mm ALLEN WRENCH OR STRAIGHT BLADE SCREWDRIVER

SOURCE DRAWING - FOR REFERENCE ONLY

NOTES:

1. "/SV" DESIGNATES SPECIAL PACKAGING FOR VENDING MACHINES.

RELATED DOCUMENTS		3RD ANGLE PROJECTION		THIS DRAWING IS CONFIDENTIAL AND THE PROPERTY OF TURCK INC. USE OF THIS DOCUMENT WITHOUT WRITTEN PERMISSION IS PROHIBITED.		<p>3000 CAMPUS DRIVE MINNEAPOLIS, MN 55441 1-800-544-7769 (763) 553-7300 (763) 553-0708 fax www.turck.us</p>	
1.			ALL DIMENSIONS DISPLAYED ON THIS DRAWING ARE FOR REFERENCE ONLY	DRFT	RDS	DATE	12/09/08
2.				APVD		SCALE	1=1.0
3.		MATERIAL		UNIT OF MEASUREMENT		IDENTIFICATION NO.	
4.		SEE SPECS		INCH [MILLIMETER]		4685787	
FINISH		SEE SPECS		CONTACT TURCK FOR MORE INFORMATION		REV	
D		UPDATE SENSOR BODY AND PROTECTION CLASS		RDS		02/11/21	
76491		ECO NO.		DO NOT SCALE THIS DRAWING		FILE: 4685787	
REV		DESCRIPTION		BY		DATE	
						SHEET 1 OF 1	