

WIRING DIAGRAM

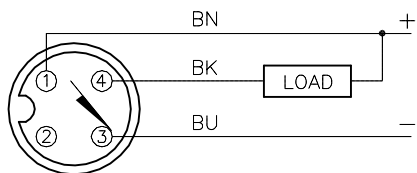

OUTPUT: AN6X

SHORT-CIRCUIT AND OVERLOAD PROTECTED

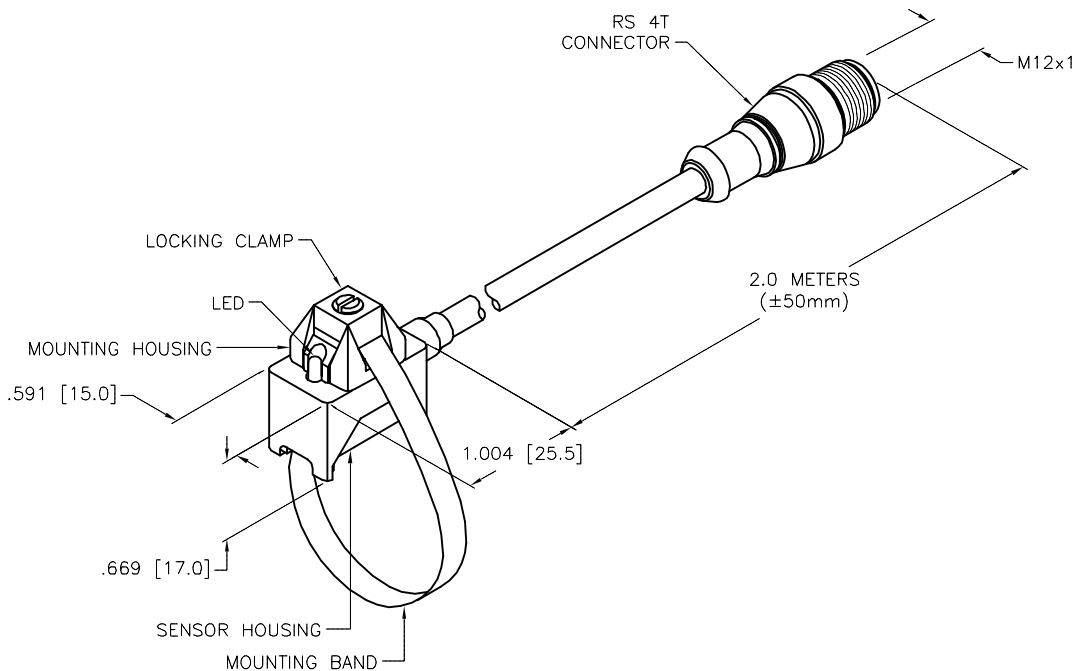

SPECIFICATIONS

| | |
|---|---|
| OPERATING VOLTAGE | 10-30 VDC (SHORT-CIRCUIT PROTECTED) |
| RIPPLE | ≤ 10% |
| HYSTERESIS | ≤ 1 mm |
| MAX. VOLTAGE DROP | ≤ 2.3 V at 200 mA |
| OUTPUT FUNCTION | NORMALLY OPEN, 3-WIRE, NPN |
| TTL COMPATIBLE | NO |
| SHORT-CIRCUIT PROTECTED | YES |
| TRIGGER CURRENT FOR OVERLOAD PROTECTION | ≥ 220 mA |
| CONTINUOUS LOAD CURRENT | ≤ 200 mA |
| RESIDUAL CURRENT | < 10μ A |
| NO-LOAD CURRENT | ≤ 15.0 mA |
| TIME DELAY BEFORE AVAILABILITY | ≤ 5 ms |
| POWER-ON EFFECT PROTECTION | INCORPORATED |
| REVERSE POLARITY PROTECTION | INCORPORATED |
| WIRE-BREAK PROTECTION | INCORPORATED |
| OPERATING TEMPERATURE | -25°C to +70°C (-13°F to +158°F) |
| ENCLOSURE | MEETS NEMA 1, 3, 4, 6, 13 AND IEC IP67 |
| SHOCK | 30 g, 11 ms |
| VIBRATION | 55 Hz, 1 mm AMPLITUDE (IN ALL 3 PLANES) |
| LED FUNCTION | YELLOW: OUTPUT ENERGIZED |
| SWITCHING FREQUENCY | 1000 Hz |
| REPEATABILITY | ≤ 0.1 mm (CONSTANT TEMPERATURE AND VOLTAGE) |
| TEMPERATURE DRIFT | ≤ 0.1 mm |
| MAXIMUM APPROACH VELOCITY | 10 m/second |
| MAGNETIC ACTUATION STRENGTH | 20-350 GAUSS (2-35 mT) |

NOTES:

1. FOR CYLINDERS WITH DIAMETERS UP TO 25 mm USE MOUNTING BAND KST-SB170; FOR DIAMETERS TO 80 mm USE KST-SB335.

| | |
|------------------|-------------------|
| 2. PART | MATERIAL |
| SENSOR HOUSING | [PA 12-GF30] |
| MOUNTING HOUSING | [DIE-CAST ZINC] |
| LOCKING CLAMP | [DIE-CAST ZINC] |
| MOUNTING BAND | [STAINLESS STEEL] |

SOURCE DRAWING - FOR REFERENCE ONLY

| | | | | | | | | |
|---|--------------------------|--|------------|--|------|-------------------------------|----------|------------------------------------|
| RELATED DOCUMENTS 1. 2. 3. 4. | 3RD ANGLE PROJECTION | THIS DRAWING IS CONFIDENTIAL AND THE PROPERTY OF TURCK INC. USE OF THIS DOCUMENT WITHOUT WRITTEN PERMISSION IS PROHIBITED. | | 3000 CAMPUS DRIVE MINNEAPOLIS, MN 55441 1-800-544-7769 (763) 553-7300 (763) 553-0708 fax www.turck.us | | | | |
| | | MATERIAL | SEE NOTE 2 | DRFT | RDS | DATE | 04/13/20 | DESCRIPTION BIM-KST-AN6X-2-RS4T |
| | | FINISH | | APVD | A.F. | SCALE | 1=1.3 | |
| | | ALL DIMENSIONS DISPLAYED ON THIS DRAWING ARE FOR REFERENCE ONLY | | UNIT OF MEASUREMENT INCH [MILLIMETER] | | IDENTIFICATION NO. 4674190 | | REV A |
| CONTACT TURCK FOR MORE INFORMATION | | DO NOT SCALE THIS DRAWING | | FILE: 4674190 | | SHEET 1 OF 1 | | |

| | | | | |
|-----|-----------------|-----|----------|---------|
| A | DRAWING RELEASE | RDS | 04/13/20 | |
| REV | DESCRIPTION | BY | DATE | ECO NO. |